



About the BLRH

The BLRH is a fixture designed for use in Hospitals where energy-efficiency, performance and ease of maintenance is essential. This luminaire is designed with the patient and medical professional in mind, offering ambient, exam, reading, and nightlight settings with color temperature options for all configurations to ensure patient comfortability.

Specifications

Supported Voltage	120-277V, 347V, 120-347V
Available Sizes	1x4', 2x2', 2x4'
Lifetime	L70 of 100,000+ hours
Lumens	Ambient 1.5L-4.5L, Exam 3.5L-15L
CCT	2700K, 3000K, 3500K, 4000K, 5000K, 6500K
CRI	80+ standard, 90+ and 95+ available
Dimming	0-10V
Mounting	Designed for T-Bar ceilings

Approvals

- Made with UL Listed components

Ordering Information

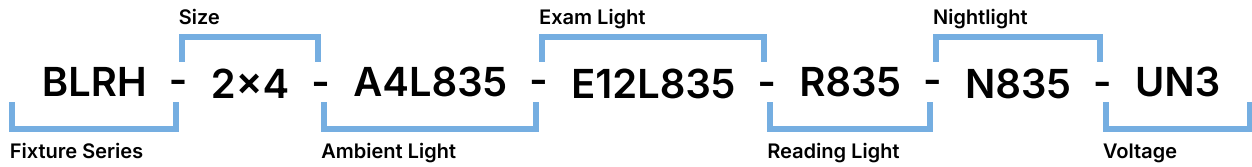

1	2	3	4	5	6
BLRH					

Series	Size	Ambient Lm	Ambient CRI	Ambient CCT	Exam Lm		
BLRH	1x4	1x4-A1.5L	8	80	27	2700K	2x2-E3.5L
	2x2	2x2-A2L	9	90+	30	3000K	2x2-E4L
	2x4	2x2-A2.5L	1	95+	35	3500K	2x2-E5L
		2x2-A3L			40	4000K	2x2-E6L
		2x4-A3L			50	5000K	2x4-E8L
		2x4-A3.5L			65	6500K	2x4-E10L
		2x4-A4L					2x4-E12L
		2x4-A4.5L					2x4-E15L

7	8	9	10	11	12	13

Exam CRI	Exam CCT	Reading CRI	Reading CCT	NightLight CRI	NightLight CCT	Voltage							
8	80	27	2700K	R8	80	27	2700K	N8	80	27	2700K	UNV	120-277V
9	90+	30	3000K	R9	90+	30	3000K	N9	90+	30	3000K	347	347V
1	95+	35	3500K	R1	95+	35	3500K	N1	95+	35	3500K	UN3	120-347V
		40	4000K			40	4000K			40	4000K		
		50	5000K			50	5000K			50	5000K		
		65	6500K			65	6500K			65	6500K		

14	

Options

Lenses

BLANK | Frosted Acrylic

Dimming

- B11 | 0-10V Dimming Leads
- B12 | Line Voltage Dimming
- B27 | Dim-to-off Driver
- B** | Other Options Available*

Emergency Driver

- B17 | UL924 10W Battery Back-up on Ambient Light
- F8 | UL924 Emergency Relay

Finish

- BLANK | Standard Matte White
- C5 | Matte Black
- CUSTOM* | Custom Colour Choice

Packaging



- BLANK | Individually Boxed on Pallets
- P0 | Bulk Packaging
- P** | Other Options Available*

Warranty

- CL7 | 10-Year Comprehensive Warranty Upgrade

Certifications and Listings

Certifications that apply to this fixture and its possible configurations are listed here. More information available upon request.

Icon	Description
	Wireless Controls Available
	90 and 95+ CRI Options Available
	120-347V(UN3) Available

Usage Applications

This fixture can be used in a variety of applications, and is ideal for the following:

Usage Application
Hospitals
Long-Term Care

Warranty Statement

BJ Take products are tested and/or inspected prior to being packaged for shipment and are guaranteed from the day the product is shipped for a period of ten-year LED chip warranty and a five-year comprehensive component warranty. This can be upgraded to a ten-year comprehensive warranty on request.

Light Configuration Diagrams

The BLRH has settings depending on the style of lighting required by the patient. Please refer to the diagram below for setting information.

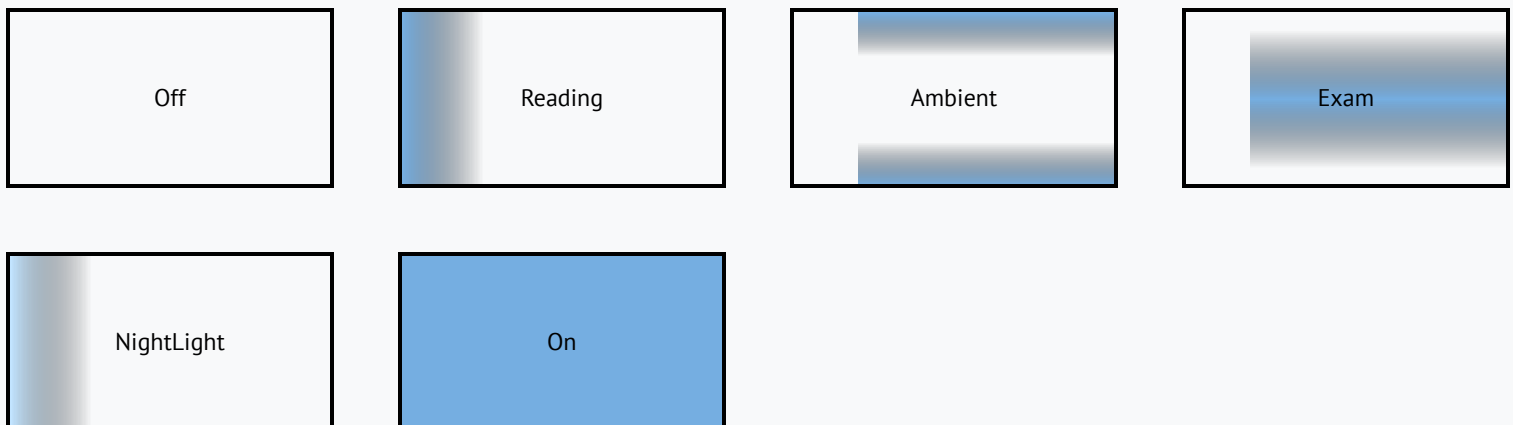

BLRH 1x4 Side Dimensions

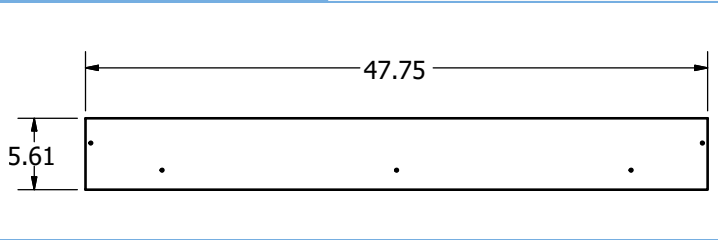

1x4 End Dimensions

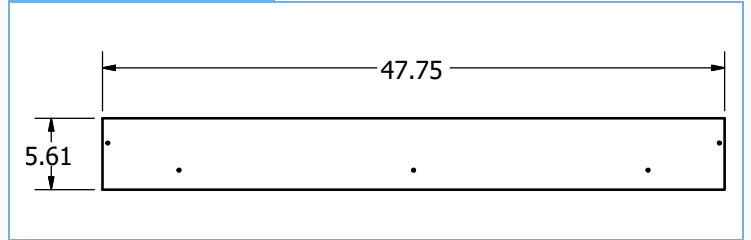

BLRH 2x2 Side Dimensions

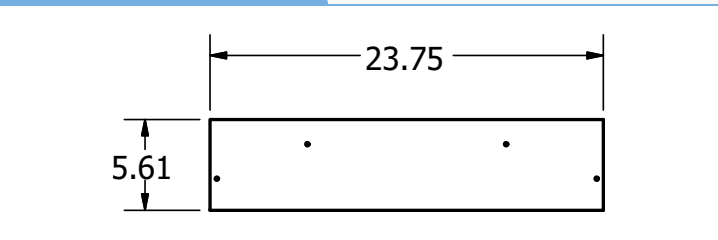

2x2 End Dimensions

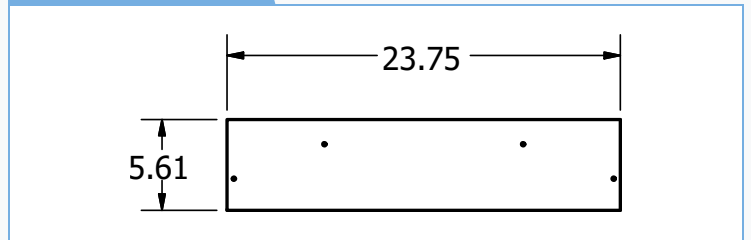

BLRH 2x4 Side Dimensions

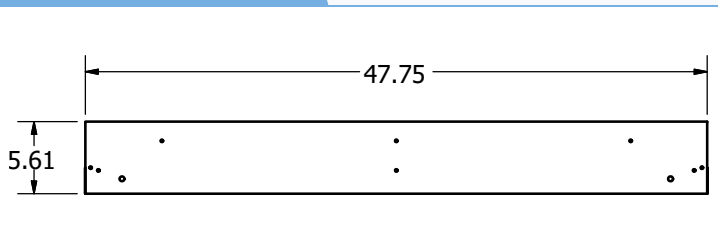

2x4 End Dimensions

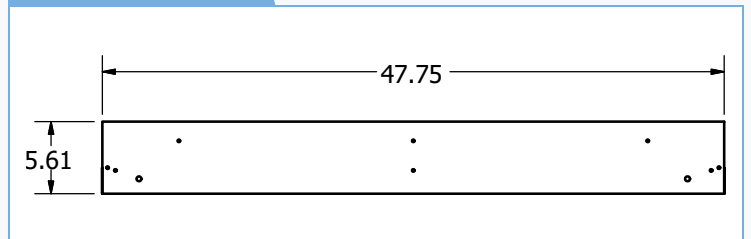

* Drawings aren't to scale
* Standard tolerances apply
* Specifications may change without notice

Gallery Information

Below you will find images of relevant products and configurations for the BLRH.

